

# User Manual



High Performance Tactical Flashlight  
<http://www.eagtac.com>  
 sku4065 GXSMX-30-L2 series

EAGTAC flashlights pack huge output lumen and far projecting beam in a very convenient and compact body. They offer versatile user interface, tough build quality and rich accessories like no other. This series is especially designed for police, professionals, and hobbyists. Be crazy lumen output with you in the dark.

## Quick Specifications

LED	CREE XHP35/XHP50.2/XHP70.2 Nichia 219 / Luminus LED
Output	5 brightness levels + AUX
Batteries	3.7V battery pack
Circuit Voltage	2.7V-4.2V



**WARNING** Lithium/Li-ion batteries can explode or cause burns if disassembled, shorted, or exposed to high temperature. Do not mix new with used batteries or other battery types, or install backwards.

## Quick Start Guide

Unscrew the tailcap and **remove the battery isolation disk** at the end of the battery to use. If your flashlight does not come with battery, insert new batteries (w/ protrude top) to use. Ensure positive terminal is facing the LED. Replace tailcap and tighten snugly.



⊕ ← Battery Isolation Disk ← ⊖  
 LED (Front) Tail-cap (Back)

### Basic ON and OFF

Turn on the light at MAX output by **pressing** the **black** button switch (release within 0.4s). To turn on the light at MIN output, **press** the **white** button switch. To turn off the light, **press and release** the **black** button switch.

For momentary on, **press and hold** the **black** button switch for immediate MAX output.

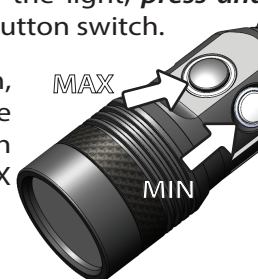

### Adjusting output level

With flashlight turned on, **press and release** the **white** button switch to cycle to the next output level.

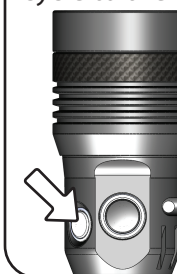

Level	Output
1st	100%
2nd	40%
3rd	13%
4th	5%
5th	1%

### Hidden AUX. settings

**Press and hold** the **white** button switch for 4 seconds to enter AUX setting. At AUX setting, press the **white** button to cycle to next AUX output. Exit AUX setting by turning off the flashlight.

AUX1 → AUX2 → ... → (Repeat)

### Battery level indicator (blue)

After turning on the flashlight or switching levels, it reports the battery capacity (estimated) by flashing itself.

# of Flash	Battery Capacity
1	<30%
2	30-50%
3	50-70%
4	>70%

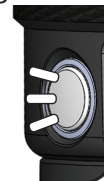

### Instant MAX output

**Press and hold** the **black** button switch for 100% output. **Release** the button to return to previous level.

### Instant Strobe output

**Double press and hold** the **black** button switch for strobe output. **Release** the button to return to previous level.

### Active thermal management

#### (Selected models only)

After 30 seconds at MAX output level, this feature activates and continuously adjusts the MAX output between 40%-100% according to flashlight internal temperature

### Customize start-up level

#### (Selected models only)

Press the **white** switch until desired brightness level is reached, then continue holding the switch until the signal LED lights up to set current brightness level as startup level.

### Diffuser output (Diffuser model)

**Press and hold** the **black** button switch and press the **white** button switch to cycle between diffused and regular output.

SPOT → DIFFUSER → ALL ON (Repeat)

Remove the waterproof cover and insert the charging plug to charge. The flashlight will switch off the LED output during charge and reports the current charged percentage by flashing its indicator.

# of Flash	Charge progress
1	<50%
2	50-75%
3	>75%
Constant ON	100% (done)



### Color and diffuser filters (optional)

(Screw-on type) Unscrew the stainless steel bezel and replace it with the screw-on filter to use.

(Cover type) Insert the filter cover directly on the flashlight head to use. The filter cover door can be locked in place using a cable tie.

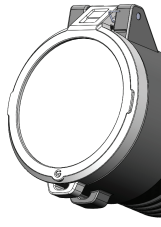

### Battery Safety Precaution

Battery with protruding positive terminal is required for this flashlight. Only use compatible battery pack with this flashlight.

Always ensure the battery outer wrapping is complete. Broken battery wrapping may lead to short circuit and damage to the flashlight.

Lithium/Li-ion battery can explode or cause burns if disassembled, exposed to high temperature, or shorted. Do not mix new/fully charged and used batteries. Do not mix batteries with different brand, capacity, voltage, or install batteries backwards.

When output starts to dim or low battery voltage warning appears, lower output level to extend runtime, and replace or recharge batteries whenever possible. It is a good practice to not drain the batteries completely. When you are not going to use the flashlight for a long period of time, remove all batteries from the flashlight.

### How to prolong battery life

Recharge often. Do not let battery stays in deeply discharged condition for a long period of time.

### Maintenance

Periodically clean the thread and o-rings with a lint free cloth and apply a thin coating of EAGTAC synthetic PTFE lubricant to the o-rings and thread. Do not touch or attempt to clean the reflector, as it will damage the reflective coating.

Troubleshooting - Flashlight does not turn on or fails to switch between outputs normally:

- 1) Check and replace batteries
- 2) Ensure tailcap is tight
- 3) Clean all conductive contacts
- 4) Check battery polarity

### "No Hassle" EAGTAC Warranty

For repair, replacement, or other inquiries contact your EAGTAC dealer. You can also reach our customer support via email at [support@eagtac.com](mailto:support@eagtac.com).

We warrant our flashlights to be free from defects in workmanship and materials. We will repair, replace at our option, without charging any product or part which is found to be defective under normal use within 120 months from the date of purchase with the proof of purchase.

Electronics, chargers and rechargeable batteries are covered for a period of 12 months with purchase receipt. Such repair or replacement shall be the purchaser's sole and exclusive remedy under this warranty. Normal wear and tear including batteries draining is not covered, nor is damage resulting from modification, misuse, abuse, neglect, faulty battery, battery leakage, reversed charging damage, improper maintenance or repaired by anyone other than EAGTAC or authorized dealer.